



Shanghai Malu Grape Park
Address: 29 Dazhi Road
Ticket: 15 yuan per person

Fourth stop: Shanghai Malu Grape Park

Shanghai Malu Grape Park is the first grape-themed park in China, known as the “Shanghai Turpan.”

Now is the season for grape growth. You can come to the grape greenhouse around 1pm to explore the grapes, observe the fruit setting and take photos. Those who enjoy the fun of farming can also go to the vegetable base to pick cucumbers and lettuce, and dig potatoes. The picking season starts from April 29th to early June, and will be open from 8am to 4pm daily.

Sixth stop: Shanghai Poly Grand Theater

If you have time, you can also go to the Poly Grand Theater to treat yourself with an art feast. The landmark building of Jiading New City was designed by world-renowned architect Tadao Ando and is an excellent place for taking photos.

Scenic spot nearby:

• Jiading Library

The library's roof is designed in the shape of an open book, reminiscent of the knowledge and wisdom it holds. Despite its modern simplicity, the library has become one of the most popular destinations in Jiading, attracting numerous visitors with its unique architecture and impressive collections.

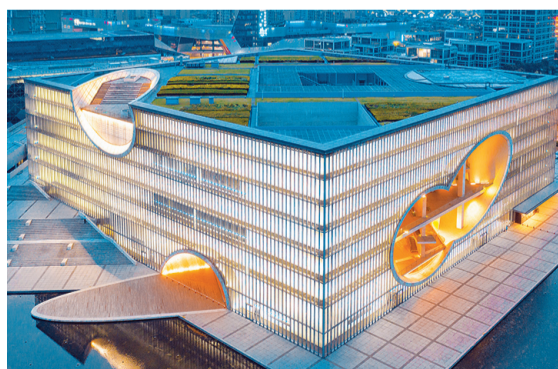

Shanghai Poly Grand Theater
Address: 159 Baiyin Road

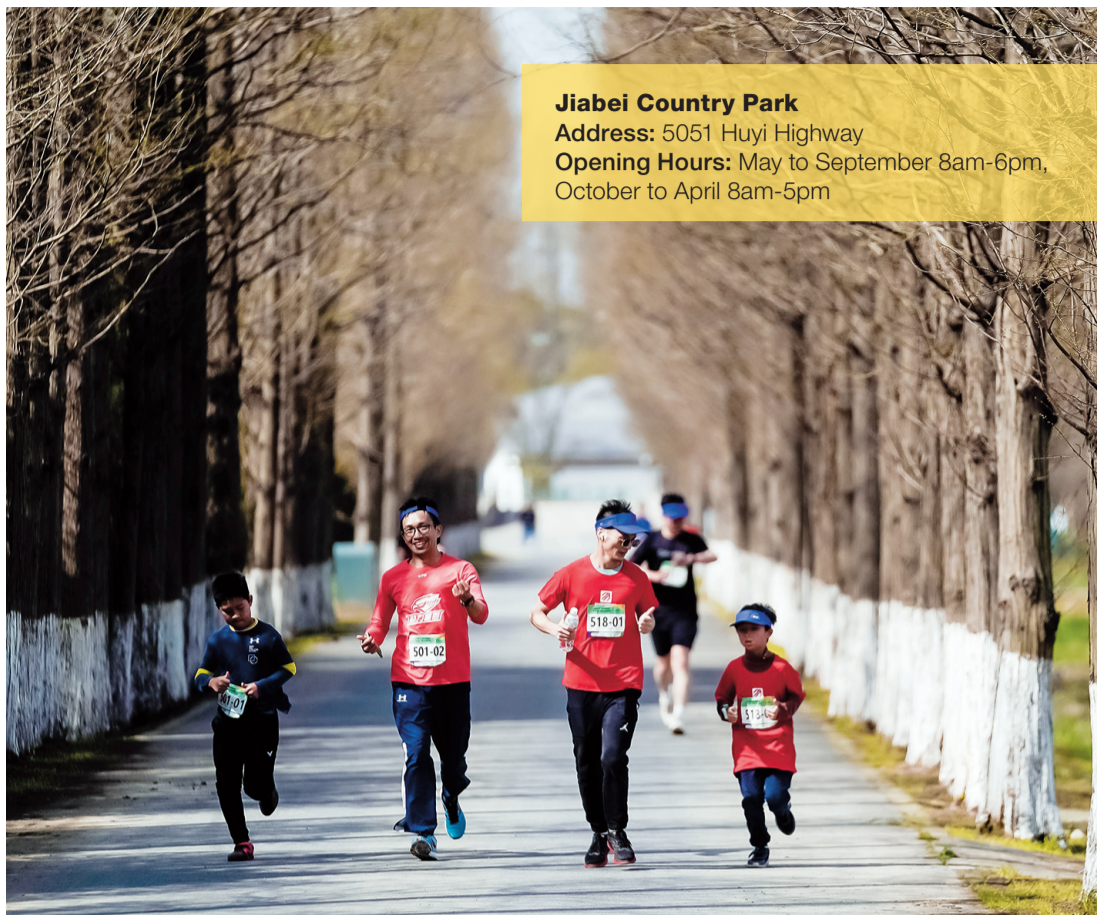

Jiabei Country Park
Address: 5051 Huiyi Highway
Opening Hours: May to September 8am-6pm,
October to April 8am-5pm

Fifth stop: Jiabei Country Park

Located in the northwest of Jiading, Jiabei Country Park boasts a range of natural features that include original ecological farmland, lush trees, and intricate water networks. As you enter the lush forest of the park, you will see three scenic thoroughfares — Shanlin Avenue, Wuzhi Avenue and Fengxiang Avenue — that intersect within the park.

These avenues, along with their crisscrossing water network bridges, serve as the main arteries of the park, connecting the farmland, sea of flowers and forest as one harmonious entity. It is highly recommended to enter the park at noon, when the sun is high and the park is at its most picturesque.

Restaurants recommended:

• Phiser Country Club

Originally a farmhouse situated near Baima Bridge in Jiabei Country Park, the Phiser Country Club was rebuilt by architects and club owners from the prestigious Central

Academy of Arts and Crafts, transforming it into a minimalist European-style building that exudes elegance and sophistication.

In addition to selling coffee, the club also offers customized services for Chinese and English afternoon tea, with an average price of around 50 yuan per person.

• Lijiang Ecological Park

Lijiang Ecological Park is in Zhuqiao Village, Jiading Industrial Zone, adjacent to the Laoliu River. It is a rural paradise that integrates leisure, entertainment, sightseeing, catering, vacation and farming.

To fully experience all the activities that the park has to offer, it is recommended to arrive at around 3pm. You can feed cows, watch goats on the farm, and even pick small tomatoes. As for meals, the park recommends trying the signature dish of Meishan Black Pig, which is sure to leave a lasting impression on your taste buds.

Seventh stop: Beishuiwan Bridge

The design concept of the Beishuiwan Bridge originated from the image of a “Leaping Dragon across Rainbow.” As night falls, a “rainbow” rises into the sky. Standing on the bridge, you can take in the mesmerizing view of the bustling Sunye Shopping Mall, which is one of the most charming landmarks in the Beishuiwan area.



Beishuiwan Bridge
Address: Middle section
of Pingcheng Road